

Greyhound Integration into Centennial Plaza

October 2018





- Largest provider of intercity bus transportation in North America



- In operation for 104 years



- Serving more than 3,800 destinations



- Currently in 168 Intermodal facilities with an additional 11 locations in process



- In times of emergencies Greyhound has provided buses to evacuate residents or to support emergency personnel
 - Hurricane Katrina
 - New York City and nationwide during September 11
- Greyhound supports teen runaway program by providing free travel back home anywhere in the United States

Greyhound North America Intermodals



Greyhound Intermodals (U.S., Canada & Mexico)				
ALBUQUERQUE, NM	ELGIN, IL	LANSING, MI	REDDING, CA	TORONTO (Airport), ON
ALTOONA, PA	ELKHART, IN	LAREDO, TX	REGINA (Airport), SK	TACOMA, WA
ANAHEIM, CA	ERIE, PA	LONGVIEW, TX	ROANOKE, VA	THOUSAND PALMS, CA
ANN ARBOR, MI	EVANSVILLE, IN	LYNCHBURG, PA	SALEM, OR	TOLEDO, OH
APPLETON, WI	EVERETT, WA	MCALLEN, TX	SALINAS, CA	TULARE, CA
ASHEVILLE, NC	FAYETTVILLE, NC	MELBOURNE, FL	SALT LAKE CITY, UT	URBANA/CHAMPAIGN, IL
ASHLAND, KY	FLINT, MI	MEMPHIS, TN	SAN DIEGO, CA	UTICA, NY
ATLANTA, GA	FORT COLLINS, CO	MERIDIAN, MS	SAN FRANCISCO, CA	VACAVILLE, CA
ATLANTA, GA (AIRPORT)	FORT MYERS, FL	MIAMI (AIRPORT), FL	SAN JOSE, CA	VALLEJO, CA
ATLANTIC CITY, NJ	FORT WORTH, TX	MIAMI WEST, FL	SAN MARCOS, TX	VICTORVILLE, CA
BALTIMORE, MD	FREDERICK, MD	MILWAUKEE, WI	SAN RAFAEL, CA	WACO, TX
BATTLE CREEK, MI	FRESNO, CA	MIDLAND, TX	SAN YSIDRO, CA	WASHINGTON D.C.
BELLINGHAM, WA	GARY, IN	MINNEAPOLIS, MN	SANTA ANA, CA	WEST PALM BEACH, FL
BENTON HARBOR, MI	GENEVA, NY	MODESTO, CA	SANTA BARBARA, CA	WHEELING, WV
BILOXI, MS	GILROY, CA	MT. LAUREL, NJ	SANTA ROSA, CA	WHITE PLAINS, NY
BINGHAMTON, NY	GLENDALE, CA	MUSKEGON, MI	SANTA CRUZ, CA	WICHITA, KS
BIRMINGHAM, AL	GRAND RAPIDS, MI	NEW CARROLLTON, MD	SAVANNAH, GA	WICHITA FALLS, TX
BOSTON, MA	GREEN BAY, WI	NEW HAVEN, NJ	SEATTLE, WA	WINSTON SALEM, NC
BRIDGEPORT, CT	GREENSBORO, NC	NEW LONDON, CT	SHERMAN, TX	WOODBIDGE, VA
BUFFALO, NY	GREENVILLE, SC	NEW ORLEANS, LA	SHREVEPORT, LA	WORCESTER, MA
CAMDEN, NJ	HAMPTON, VA	NEW YORK, NY	SILVER SPRING, MD	YOUNGSTOWN, OH
CHAMPAIGN, IL	HARRISBURG, PA	NEWARK, NJ	SKOKIE, IL	GUELPH, ON
CHICAGO, IL (AMTRAK)	HARTFORD, CT	NEWTON, MA	SOUTH BEND, IN	KITCHENER, ON
CHICAGO, IL (DAN RYAN)	HAYWARD, CA	NORFOLK, VA	SOUTHFIELD, MI	MONTREAL, QC
CHICO, CA	HUNTINGTON, VA	OCALA, FL	SPARTANBURG, SC	TORONTO (TCT), ON
COMPTON, CA	INDIANAPOLIS, IN	OCEANSIDE, CA	SPOKANE, WA	VANCOUVER, BC
CORPUS CHRISTI, TX	JACKSON, MS	OGDEN, UT	SPRINGFIELD, MA	VICTORIA, BC
DAYTON, OH	JACKSONVILLE, FL	OXNARD, CA	SPRINGFIELD, VA	WINDSOR, ON
DETROIT, MI	JOHNSON CITY, TN	PALMDALE, CA	ST. LOUIS, MO	WINNIPEG (AIRPORT), MB
DURHAM, NC	JOPLIN, MO	PASCO, WA	ST. PAUL, MN	YORKDALE, ON
EAST LANSING MI	KALAMAZOO, MI	PHILADELPHIA, PA	STAMFORD, CT	MEXICALI
EDMONTON, AB	KEYWEST, FL	PITTSBURGH, PA	SYRACUSE, NY	TIJUANA (AIRPORT)
EL CAJON, CA	LAFAYETTE, LA	PONTIAC, MI	SUISUN CITY, CA	
EL MONTE, CA	LANCASTER, PA	PORTLAND, OR	THE DALLES, OR	

Planned
CHATTANOOGA, TN
EUGENE/SPRINGFIELD, OR
OLYMPIA, WA
RALEIGH, NC
COLORADO SPRINGS, CO
EL PASO, TX
PROVIDENCE, RI
SACRAMENTO, CA
SPARKS, NV
INDIO, CA
AMARILLO, TX

GRAND TOTAL 168

179

11



- Increased and affordable travel options for local residents



- Greyhound complies with ADA (American Disabilities Act) for its buses and facilities



- Increased utilization of publicly funded transit transfer center



- Increased connectivity and convenience for both intracity and intercity travel



- Close proximity of Centennial Plaza to Interstate freeway limits bus traffic on city streets
- Potential future employment opportunities
- Increased revenue to local businesses derived from travel activity



Age Demographics

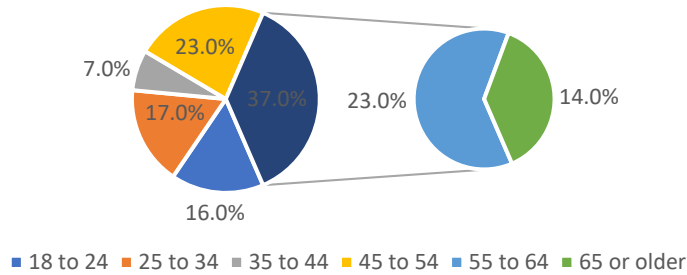

- 37% of Greyhound riders are over the age of 55 while 60% are over the age of 45.

Ethnicity

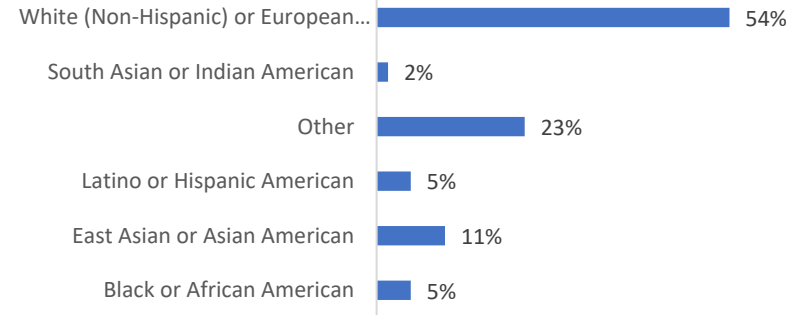

Employment Status

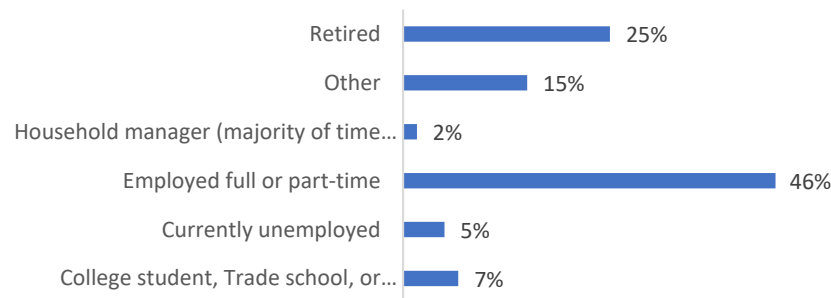

- Only 5% of Greyhound riders identify themselves as unemployed which matches the Nevada state rate for March 2018.

Key Takeaways

- Overall, Greyhound Passengers are an equal representation of the demographics of their community in Truckee Meadows
- Greyhound provides an affordable travel option to the people of Truckee Meadows as well as those traveling in from across the country



Site Photo
(looking North from I-80)

Site Plan

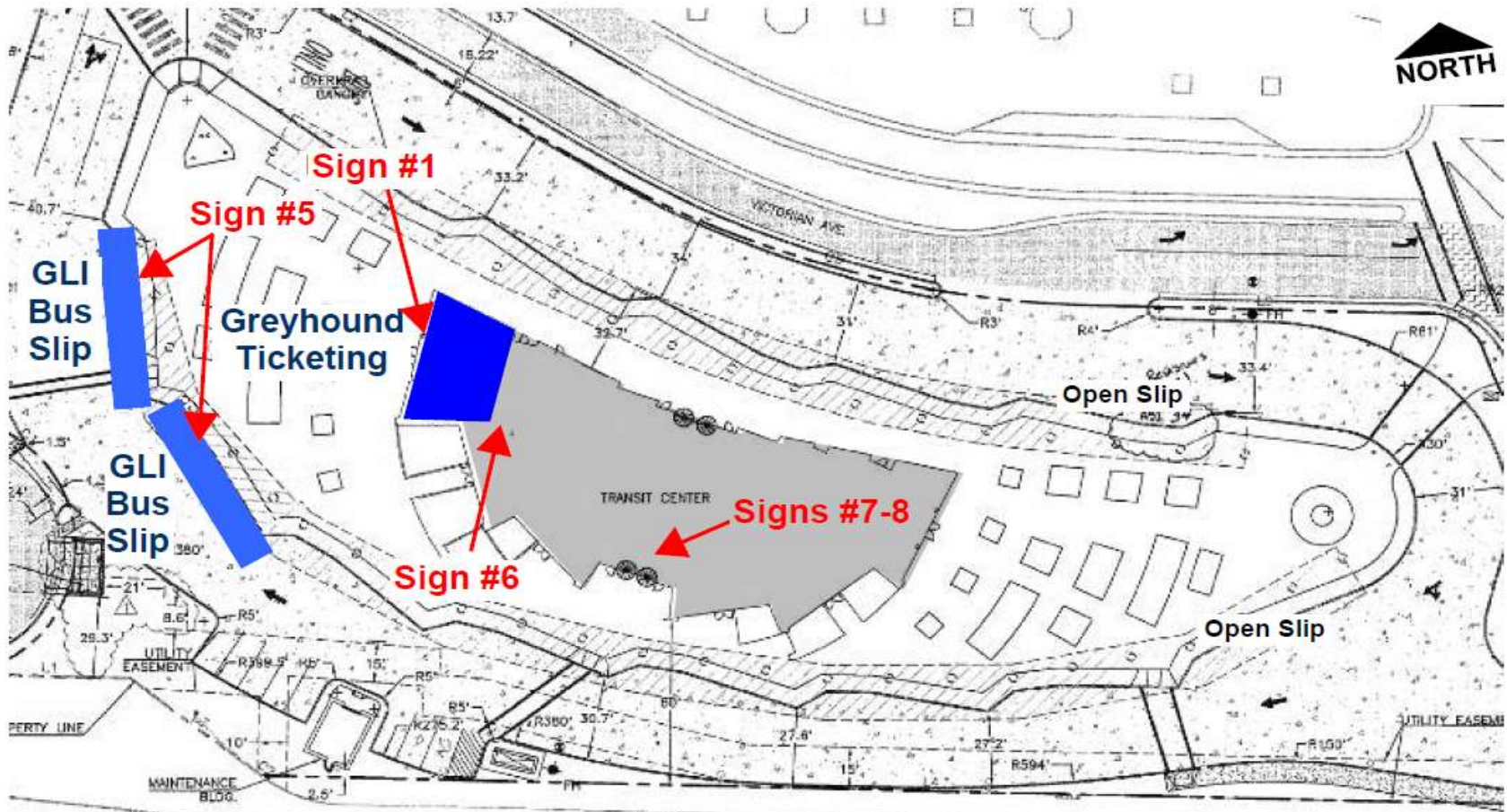

Site Plan

Centennial Plaza Interior Space Plan

Lease Space Plan

Note:
Dimensions are per as-built drawing
(.pdf file) and must be verified

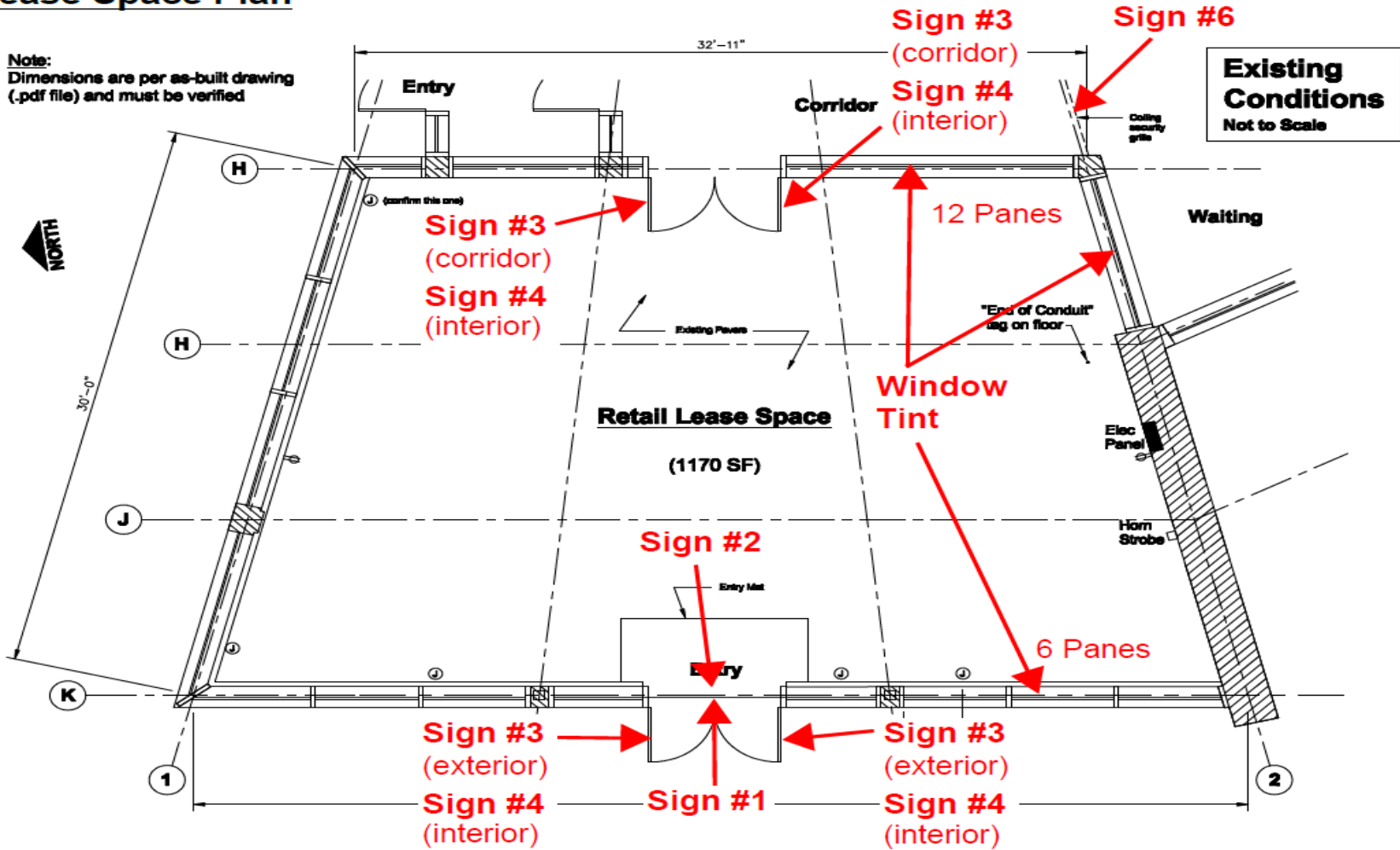

Proposed Centennial Plaza Tenant Fixtures

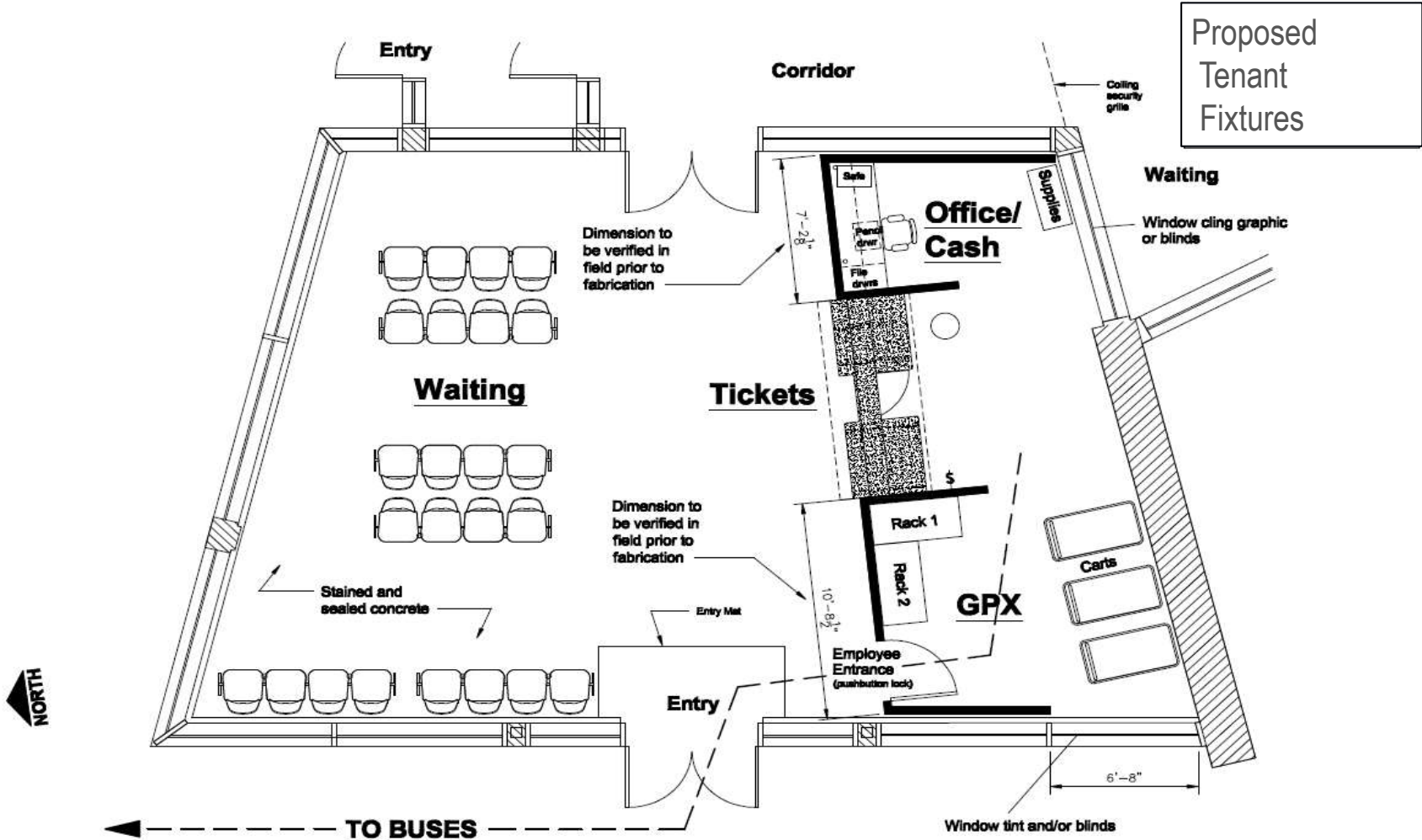

Sign #1 (1 required)



Sign #2 (1 required)



Digital print on graphic film with UV resistant overlaminates and adhesive back.

Apply to existing glass, covering entire glass panel.



Greyhound Storefront

General Notes:

1. Confirm all sign dimensions prior to fabrication - site visit required to confirm glass size and canopy column dimensions.
2. Provide barricades as required to keep public and staff away from work area.
3. Graphic film, inks and overlaminates to be UV resistant 3M products. System to provide min. 5 yr. warranty.
4. Greyhound to provide high res artwork files in .ai or .eps format.

Greyhound Signage



Sign #4 (4 required)

Same size as Sign #3



Digital print on graphic film with UV resistant overlamine and adhesive back.

Center on door glass @ 60" above floor.



Sign #3
(exterior)

Sign #4
(interior)

Greyhound Storefront

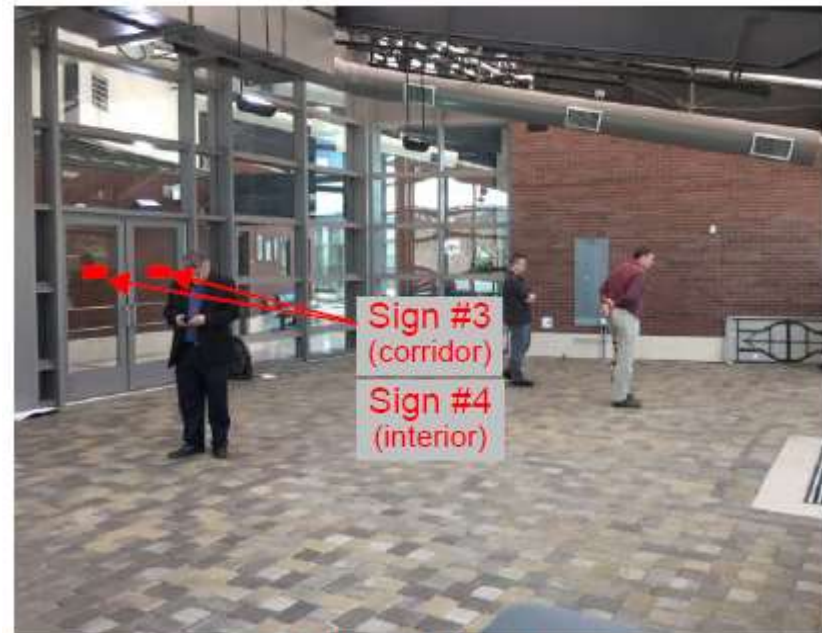

Sign #3
(corridor)

Sign #4
(interior)

Greyhound Lease Space

Sign #5 (8 required)



Digital print on graphic film with UV resistant overlamine and adhesive back.
Apply to existing canopy columns.
Match dimensions and mounting height of Megabus sign.



Greyhound Bus Stops



Example of Sign #5

Greyhound Signage

Sign #6 (1 required)



Digital print on graphic film applied to black 3mm Sintra panel.
Match dimensions of coiling gate sheet metal housing.
Secure to housing with industrial grade double-sided foam tape (do not screw into housing)



Lobby - Looking Toward Greyhound Space



- Negotiate key lease terms with RTC and execute lease.
- Proceed with necessary tenant fixtures at Centennial Plaza.
- Relocate Greyhound operations early to mid December 2018.

Fresno Interior Images (for reference)

